

Instructions for: BSD1111

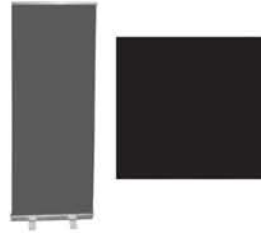

Important: This process is best accomplished on a large horizontal surface with two people. DO NOT remove the pin until you have reached the appropriate step in the directions.

Note: Design and print the banner to accommodate the 6 to 8 inches that are rolled up inside the base.

STEP 1 Remove contents from the carrying case. You will find the retractor base, a shock-corded support bar (stored within the base) and a header bar.

STEP 2 The header bar is actually a snap rail to hold the top of your cut banner. Remove the rubber end caps from each end of the header bar.

STEP 3 Place the banner down on a flat surface. Slide the top edge of the banner into the rail. Press firmly to lock banner into the rail. Replace end caps.



STEP 4 Lay the banner out flat, right side down. On the retractor base you will find two strips of paper. Remove them to expose the adhesive.

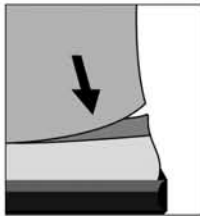

STEP 5 Firmly and evenly press the bottom of the banner onto the adhesive.

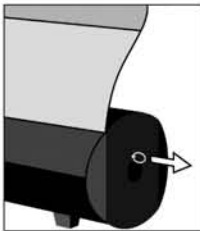

STEP 6 Maintain tension on the banner while slowly removing the pin. Allow the banner to gently roll into the canister.

STEP 7 When you are ready to display the banner, rotate the feet so they are perpendicular to the base. Join the three tubes of the shock-corded bar so they form one long unit. Place the end of that unit into the hole at the center of the retractor base.

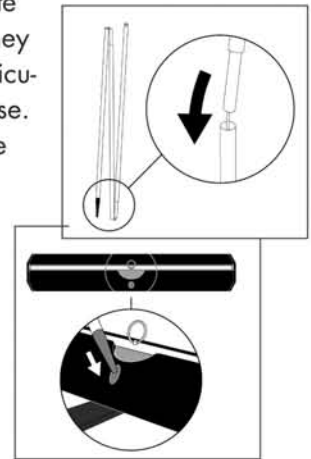

STEP 8 Gently pull the banner out of the canister. Attach the header to the top of the support bar.

When you are ready to retract the banner, simply lift the banner off the support bar and let it slowly wind into the base.